





EX-CELL KAISER
11240 MELROSE AVENUE
FRANKLIN PARK, IL 60131
PHONE: (847) 451-0451
FAX: (847) 261-9448
www.ex-cell.com

☒ SELECT DESIRED BODY (LASER CUT GRAPHIC):

- ☐ TRASH (WHITE BACKING) 
- ☐ RECYCLING (GLOSS WHITE BACKING) 
- ☐ CUSTOM

☒ SELECT DESIRED FINISH:

- ☐ CUSTOM - ANY RAL COLOUR MATCH
- ☐ STANDARD TRASH - (BLACK GLOSS)
- ☐ STANDARD RECYCLING - (RECYCLE BLUE GLOSS)
- ☐ STAINLESS STEEL (TYPE 304, #4 FINISH)

☒ SELECT DESIRED LID FINISH:

- ☐ BLACK MATTE
- ☐ RECYCLE BLUE MATTE

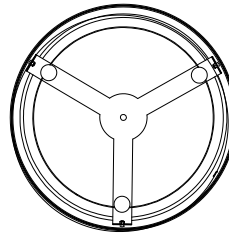

BOTTOM VIEW

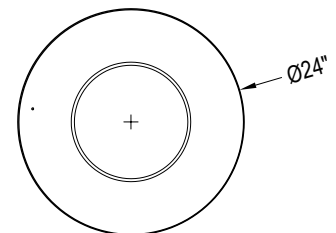

TOP VIEW

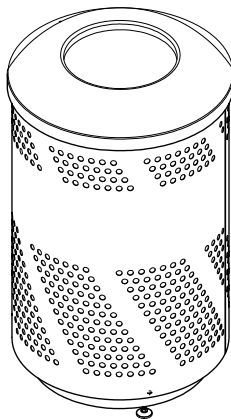

PERSPECTIVE

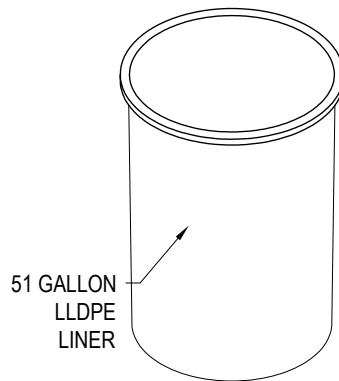

PERSPECTIVE
51 GALLON LINER

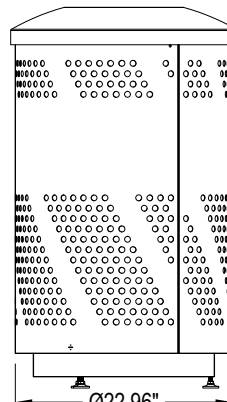

SIDE VIEW

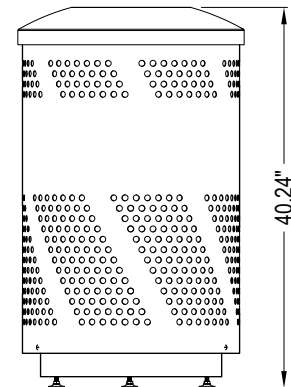

FRONT VIEW

SPECIFICATIONS:

BODY: 16 GA POWDER COATED FINISH, OR 304 SS #4 FINISH, PERFORATED IN UNIQUE SPIRAL PATTERN. SEAM WELDED CONSTRUCTION.

LID: HDPE - LID IS SECURED TO BODY WITH A PVC COATED LANYARD CABLE. LID OPENING: 12" DIAMETER.

LINER: UL-94 RATED RIGID LEAKPROOF LINER, 51 GALLON CAPACITY, LLDPE FITS SNUGLY OVER EDGE OF CAN

BASE: BLACK GLOSS POWDER COATED BASE IS ATTACHED TO BODY WITH STAINLESS STEEL HARDWARE.

-UNIT SITS ON 3 PLASTIC ADJUSTABLE LEVELING GLIDES WHICH ARE SCREWED INTO BASE OF UNIT

-CUSTOM LASER GRAPHICS CAN BE ANY WORDING OR LOGO IN 9" X 16" AREA, 1-3 TIMES AROUND CENTER BAND, WHITE BLACK OR ANY RAL COLOUR BACKING SHEET

NOTES:

1. INSTALLATION TO BE COMPLETED IN ACCORDANCE WITH MANUFACTURER'S SPECIFICATIONS.
2. DO NOT SCALE DRAWING.
3. THIS DRAWING IS INTENDED FOR USE BY ARCHITECTS, ENGINEERS, CONTRACTORS, CONSULTANTS AND DESIGN PROFESSIONALS FOR PLANNING PURPOSES ONLY. THIS DRAWING MAY NOT BE USED FOR CONSTRUCTION.
4. ALL INFORMATION CONTAINED HEREIN WAS CURRENT AT THE TIME OF DEVELOPMENT BUT MUST BE REVIEWED AND APPROVED BY THE PRODUCT MANUFACTURER TO BE CONSIDERED ACCURATE.
5. CONTRACTOR'S NOTE: FOR PRODUCT AND COMPANY INFORMATION VISIT www.CADdetails.com/info AND ENTER REFERENCE NUMBER 5283-057

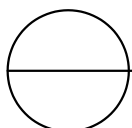

ARENA 51 COLLECTION

51 GALLON INDOOR RECEPTACLE (ARENA-51)