

## WR-MT KIT INSTALLATION

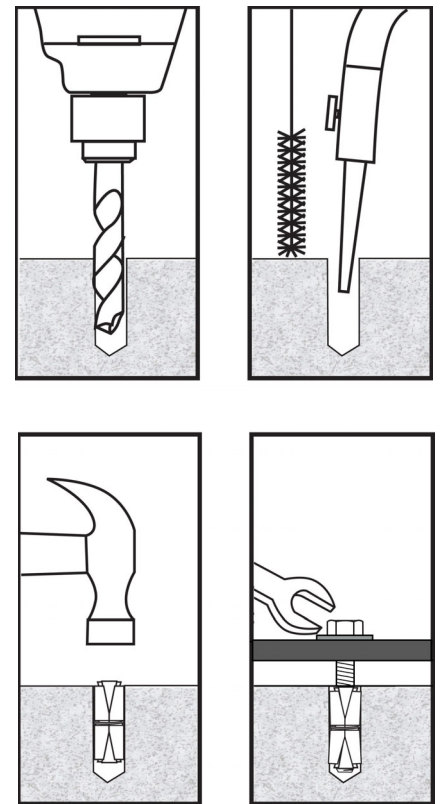
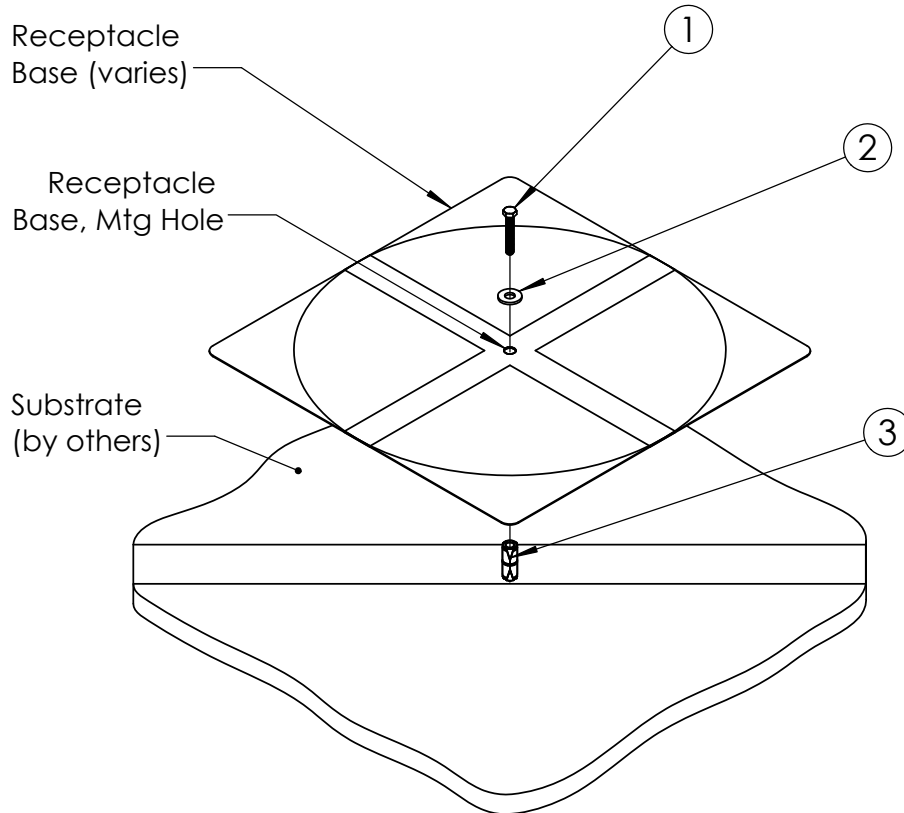

ITEM NO.	DESCRIPTION	QTY.
1	Steel Hex Head Screw, 5/16-18 x 2"	1
2	Hot-Dipped Galvanized Steel Washer, 1" OD x 7/16" ID	1
3	Double Expansion Anchor, 5/16"-18 (1-5/8"L)	1

### Instructions

1. Determine desired placement of receptacle and mark center on substrate surface.
2. Use a 5/8" dia drill bit appropriate for your substrate and drill to 1-5/8" minimum depth.
3. Clean debris from hole using wire brush, vacuum, and/or compressed air.
4. Insert anchor into hole (threaded end first) and tap with hammer until anchor is flush with surface.
5. Place receptacle over the anchor, aligning the mounting hole with the ground anchor.
6. Thread the bolt through the mounting hole and into the anchor in the ground. Tighten the bolt using a 1/2" socket, if necessary. Avoid over tightening the bolt, as this can distort the metal bottom of the receptacle.